

Instinct 8 Framed Quadrant Doors Shower Enclosures Sliding Doors + Fixed Panels



Instinct 8 Framed Quadrant with fixed Panel

Specification

Frame Finish	Chrome
Glass Finish	Clear
Covers Finish	Chrome
Fixings	Concealed
Seals	Cushioned magnetic close
Dimensions	1950(h) mm
Weight	See below

Features

Handle	Double stainless steel handle
Bearings	Easy clean double rollers for a smooth sliding opening action
Assembly	Quick fix assembly system
Safety Standard	CE EN 14428
Components	See following page

Single Quadrant Doors

	Size	Adjustment	Weight
INS02XHN	900mm	860/880mm	60kg

Single Offset Quadrant Doors

	Size	Adjustment	Weight
INS02OON	900 x 760mm	860 / 880-720 / 740mm	52kg
INS01EHN	1000 x 800mm	960 / 980-760 / 780mm	59kg
INS02QHN	1200 x 800mm	1160 / 1180-760 / 780mm	65kg
INS02RHN	1200 x 900mm	1160 / 1180-860 / 880mm	72kg

Key Features + Benefits

10 Year Guarantee	8 mm Glass Thickness	 Easy Clean Glass	 Fully Reversible	 Cushioned magnetic close	 Easy Installation
-----------------------------	--------------------------------	----------------------	----------------------	------------------------------	-----------------------

Certifications + Accreditations



Merlyn Showering

Merlyn House, Unit 8, Purcellsinch Industrial Estate, Dublin Road, Kilkenny R95 HP71 Ireland. Tel: Freephone 0808 1011 429 Email: spec@merlyn.ie

All information on the data sheet is correct at the time of publication. All measurements are approximate and subject to standard tolerances.

Technical Data Sheet | Shower Enclosures

Instinct 8 Framed Quadrant Doors Shower Enclosures Sliding Doors + Fixed Panels

Components

No.	Description	Qty	Part No.
1	Cover cap for wall profile L/R	2	B08060L/B08060R
2	Screw ST4x30	8	A2403001
3	Flat head screw ST4x12	6	A2401201
4	Ø6 x 30 wall plug	8	B08070
5	Cover strip clip	10	B08054
6	Wall profile	2	INS001
7	Cover strip	2	INS007
8	Flat fixed panel	1	A
9	Fixed panel top & bottom seal	4	INS0412
10	Upright water seal for fixed panel	1	INS034
11	Handle (with glass hole distance of 250mm)	1	INSHAN250

No.	Description	Qty	Part No.
12	Bottom double roller	2	MB0082
13	Moving panel	1	B
14	Curved fixed panel	1	C
15	Upright water seal for moving panel	1	INS036
16	Upright water seal for curved fixed panel	1	INS037
17	Cover cap for upright profile	2	B08062
18	Roller stop L/R	4	B08065L/B08065R
19	Glass clip L/R	4	INS046L/INS046R
20	Top double roller	2	B08074
21	Top and bottom rail	2	D
22	Roller stop screw St4x10	4	B08089
23	Glass clip screw St4x15	4	INS050

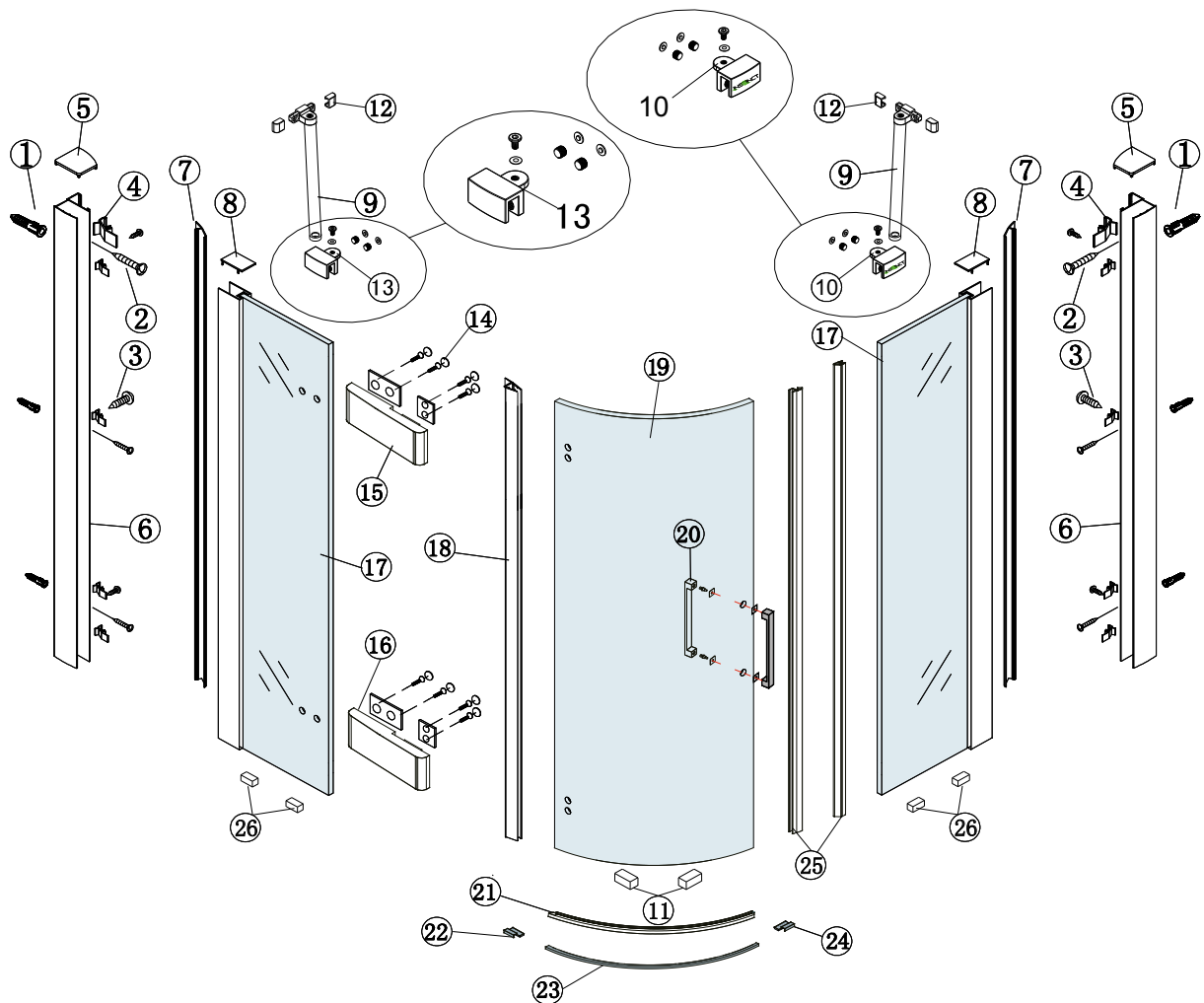

Merlyn Showering

Merlyn House, Unit 8, Purcellsinch Industrial Estate, Dublin Road, Kilkenny R95 HP71 Ireland. Tel: Freephone 0808 1011 429 Email: spec@merlyn.ie

All information on the data sheet is correct at the time of publication. All measurements are approximate and subject to standard tolerances.