

# Atlas

## 47CM CORNER BASIN 1TH



<b>Product Code</b>	<b>ASWHCBA1</b>
<b>Weight (Kg)</b>	8.7
<b>Material</b>	Vitreous China
<b>Tap holes</b>	1
<b>Fixings</b>	Bracket - BRACK / Fixing bolts
<b>Extras</b>	Bottle trap - BOTRAPCH / Waste - TROPNEW

### Key features:

- UKCA Compliant
- Chrome effect overflow ring
- Internal overflow
- Lifetime ceramic guarantee\*

### Description:

Corner basins are ideally suited for cloakrooms and smaller bathrooms where space is at a premium. This basin is also perfect for commercial applications, mounting without the use of a pedestal.

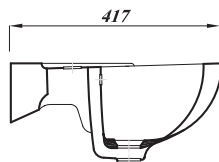
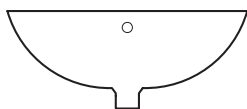

417

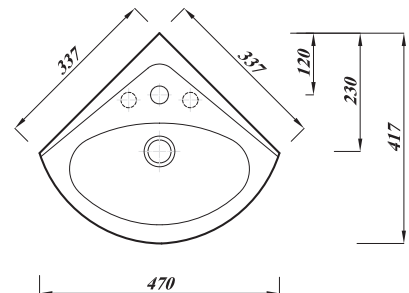

All dimensions are approximate and subject to normal variation. Although every effort is made to change the above product specification, Lecico reserve the right to do so without prior notification if necessary. All guarantees are against manufacturers defects. Full information on guarantees available upon request.